

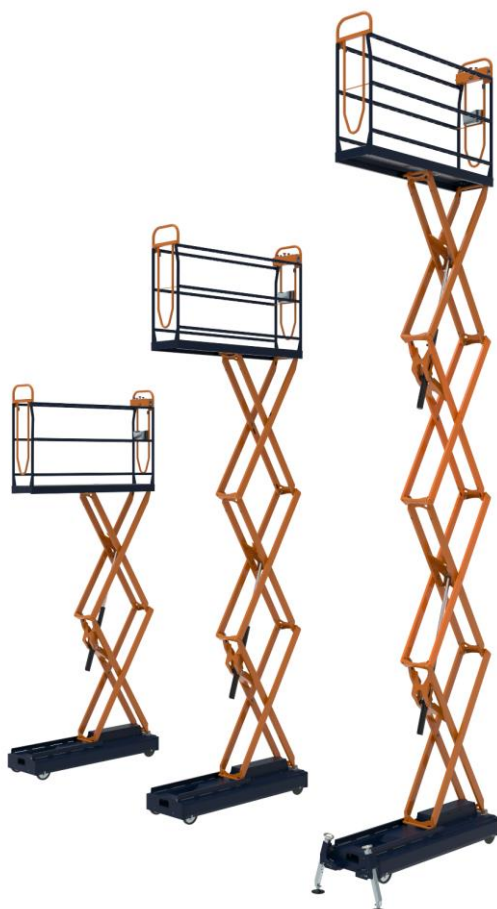

Benomic

VALVE CHECK IN PUMP

NOVEMBER 2020 VERSION: BHM202007A



Berg Hortimotive
Burg. Crezeelaan 42a
2678 KZ De Lier
The Netherlands

Phone +31 (0)174-517 700
info@berghortimotive.com
berghortimotive.com

Service
Phone +31 (0)174-613 293
service@berghortimotive.com

Failure: The scissors goes down slowly without pushing any button, or the Benomic does not stay on the lifting wheels.

Cause: Most likely the possible cause is a leaking valve, caused by dirt.

Step 1: First move the scissor up by turning the service switch, after this you can remove the cover.



Step 2: Turn up the yellow safety scissor block. After this you can lower the scissors until it hits the yellow safety scissor block.



Step 3: Turn the Benomic off.



Scissor valve

Step 4: Please disassemble the solenoid. (tool size 20)

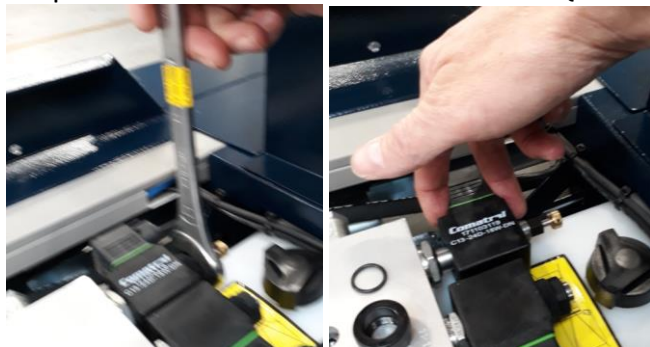

Step 5: Take out the valve from the pump-unit (tool size 24)

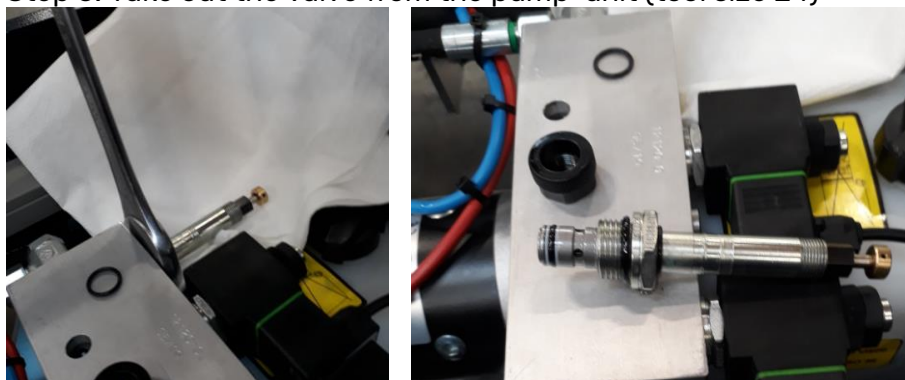

Step 6: Blow with air pressure the dirt out of the valve, push on the button so that the valve is switched open.

Please try to blow in to one of the 4 holes and block the other 3 holes with your fingers.

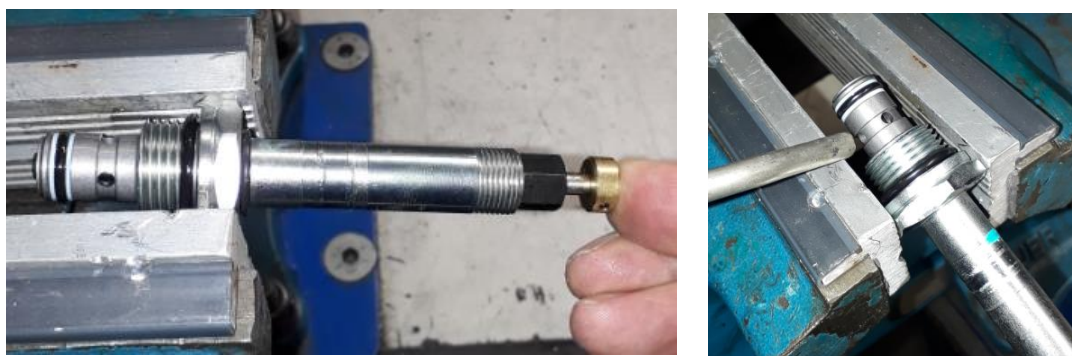

After this the valve should be cleaned, and can be installed again, so you can check if the problem is solved.

When the above handling have not resulted in the platform to keep its height, our advice is to repeat the procedure for at least one more time.

Otherwise the valve has to be replaced by a new one.

The part number is: **Scissor valve : 3030.00.0018**

Lifting wheels valve

Step 4: Please disassemble the solenoid. (tool size 20)



Step 5: Take out the valve from the pump-unit (tool size 24)



Step 6: Blow with air pressure the dirt out of the valve, please push careful with a screwdriver into the end of the valve, which will open the valve.

Please try to blow in to one of the 4 holes and block the other 3 holes with your fingers.



After this the valve should be cleaned, and can be installed again, so you can check if the problem is solved.

When the above handling have not resulted in keeping the Benomic to stay on the lifting wheels. We recommend to replace the valve.

The part number is:

Lifting wheels valve : 3030.00.0017